



33800 Lear Industrial Parkway, Avon, OH 44011

1-888-333-1134

Installation Videos Available on  YouTube

www.MainAccess.com



Item # 200700T Smart Choice Ladder

Attention: DO NOT return product to store!

If you have any damaged or missing components,

Please contact Main Access customer service for immediate assistance:

1-888-333-1134 or Info@MainAccess.com

Assembly videos available at MainAccess.com or on  YouTube

Be sure to check out the wide variety of products that Main Access offers!



Use with Models #200740T Comfort Incline, #200600T Smart Step, and 200400T Easy Entry Step



Comfort Incline



Smart Step



Easy Entry Step



SMART CHOICE LADDER

Model #200700T Assembly Instructions

Ladder Components	Qty
A) Handrails	2
B) Platform	1
C) Adjustable Support Feet	2
D) Outside Ladder Body	1
E) Ladder Foot Extension	1
G) Adjustable Support Tube	2
H) Support Tube Base	1
I) Ladder Secure Straps	2

Hardware Kit (not shown)	Qty
J) 3/8" x 4" Carriage Bolt	4
K) 3/8" Hex Nut	4
L) 3/8" Flat Washer	4
M) #14 x 3/4" Tapping Screw	6
P) 1/4" x 2-1/4" Phillips Head Bolt	2
Q) 1/4" Acorn Nut	2
R) 1/4" Flat Washer	2
S) 1" Pan Head Screw	8
T) Lock Cable	1

Supplies Required: Phillips screwdriver or bit, drill, 1/8" bit, tape measure, 7/16" and 9/16" sockets, box or open end wrenches, padlock.

Note: Before you begin the assembly of your ladder/step, please insure you have all components and hardware.

Note: Contact our customer service department to request any missing or damaged parts or hardware at 888-333-1134.

SAFETY INSTRUCTIONS:

- Install ladder per manufacturer's instructions.
- Locate ladder on a solid base.
- Ladder is designed for use by one person at a time.
- This ladder is intended for use as a swimming pool ladder only.
- Face ladder when entering and exiting the pool.
- No jumping, no diving from ladder.
- Do not swim through, behind or around the ladder or step system.

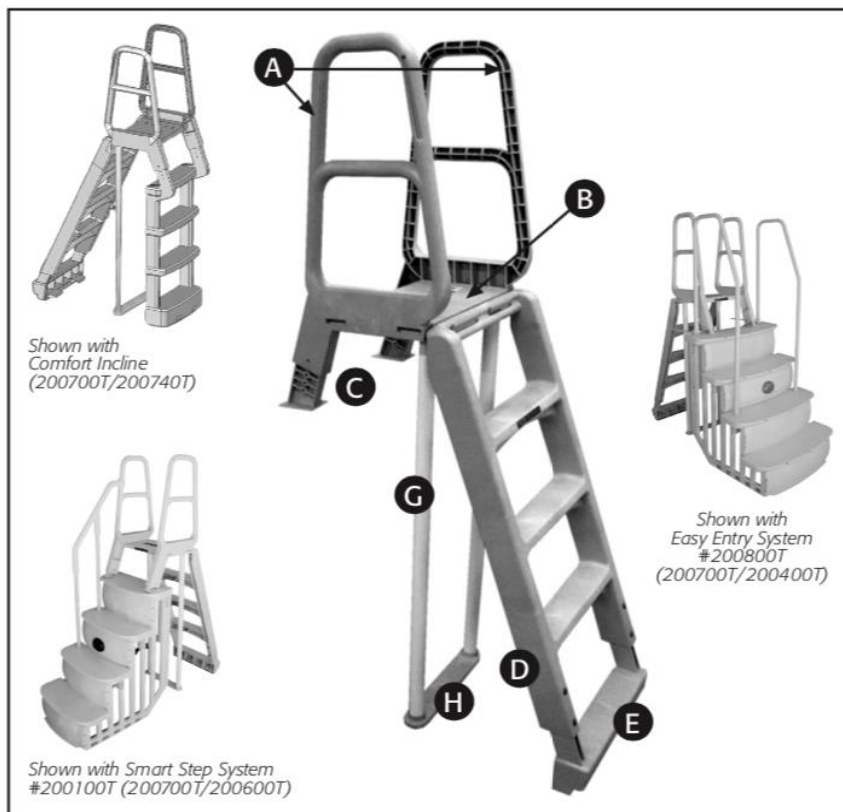

****Replacement Parts Available at MainAccess.com****

Step 1: Snap handrails into platform tabs with receivers facing opposite of platform rungs.



Step 2: Insert Support Feet into Handrail receivers.



Step 3: Place 1/4" x 2-1/4" Phillips Head Bolt into desired position.



Step 4: Use 1/4" flat washer and hex nut to secure bolt.



Step 5: Use a phillips-head screwdriver and pliers to tighten carriage bolt.



Step 6: Repeat steps





SMART CHOICE LADDER

Model #200700T Assmebly Instructions

Step 7: Insert the Ladder Foot Extension into the end of the Outisde Ladder Body.

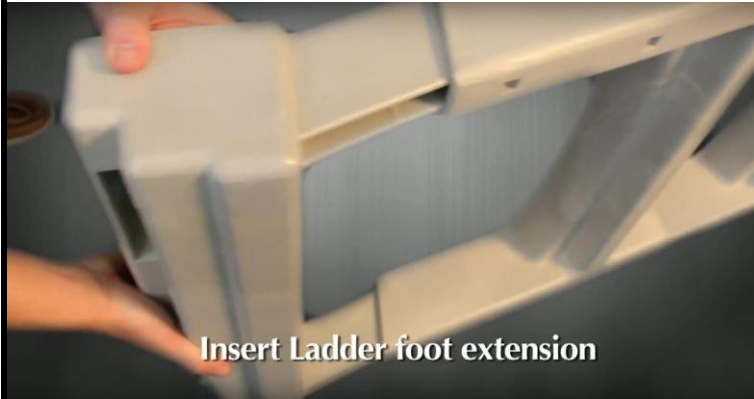

Step 8: Place 3/8" x 4" Carriage Bolts through the Outside Ladder Body and Ladder Foot Extension.



Step 9: Place 3/8" Flat Washers and Hex Nuts over the Carriage Bolts.



Step 10: Repeat steps 8 & 9 on opposite side.



Step 11: Use pliers to tighten all Hex Nuts.



Step 12: Insert Adjustable Support Tubes into the Support Tube Base.



Step 13: Attache Support Tubes under the Handrails and Platform assembly.



Step 14: Using a 1/8" drill-bit, pre-drill holes through the Support Tubes through the Platform.



Step 15: Secure the Support Tubes to the Platform using the #14 x 3/4" screws.



Step 16: Repeat steps 14 & 15 to attach the Support Tubes to the Support Tube Base.



Step 17: Attach the Outside Ladder Body to the Platform receivers.



Step 18: Secure the Platform to the pool top rail by weaving the straps through the Platform and under the pool top rail, securing outside the pool.

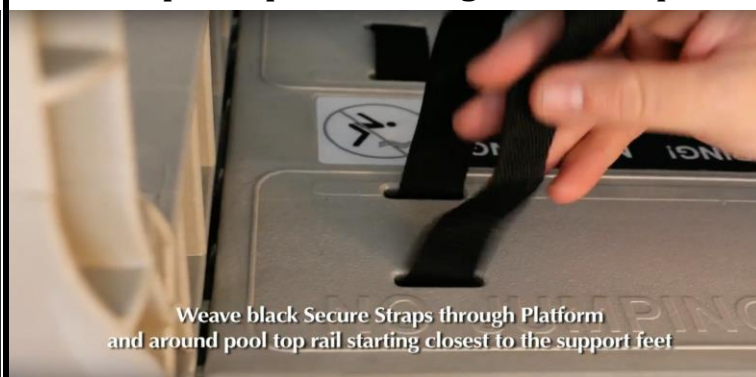

IMPORTANT: The Platform must be resting on the pool top rail and secured by either straps or bolts.



SMART CHOICE LADDER

Model #200700T Assmeby Instructions

Step 19: When not in use, remove ladder and secure in upright position by resting Ladder Foot Extension on the Platform receivers.



Step 20: Snap Outside Ladder Body tab into slot in the Handrail to secure.



Step 21: Use Lock Cable & Padlock (not included) to secure ladder onto top Handrail.

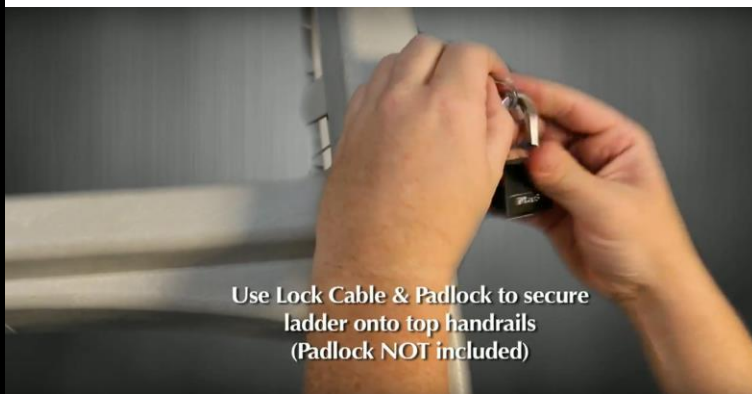

For use with Comfort Incline, slide handrails directly over ladder body and attach with Phillips Head Bolt, Flat Washer, and Lock Nut.



For use with Smart Step System, center Support Feet on top step. Secure feet using (8) 1" screws through hash marks on Support Feet (C).



Smart Step Cont'd: Attach Upper Rail to Smart Choice Handrail using Smart Connector and (2) 1" screws.



Model #200700T

For use with Easy Entry Step: Align Support Feet (C) over markings on Easy Entry Step Upper Step Tread (A1).



Easy Entry Cont'd: Attach Support Feet C to Upper Step Tread using the (8) 1" screws.



Other Recommended Products From Main Access



Mount it to your step or hang it from the return!



Use them to easily weigh down your pool step!

AQUA CLOUD
OVERSIZED FLOATING MATTRESS



Luxury Pool Floats!



Light-up Floating Globes and Furniture!



33800 Lear Industrial Parkway, Avon, OH 44011

1-888-333-1134

www.MainAccess.com

Installation Videos Available on  YouTube



Smart Step Model #200600T

Attention: DO NOT return product to store!

If you have any damaged or missing components,
Please contact Main Access customer service for immediate assistance:

1-888-333-1134 or Info@MainAccess.com

Assembly videos available at MainAccess.com or on  YouTube

Be sure to check out the wide variety of products that Main Access offers!

AQUA CLOUD
OVERSIZED FLOATING MATTRESS



Illuminate Your Life



The Anchor



SmartLite



Assembly Instructions for Model #200600T Smart Step

(For use with Model #200700T Smart Choice Ladder)



SMART STEP

Model #200600T Assembly Instructions

For use with Model #200700T (Smart Choice Ladder) to create the Smart Step System

Smart Step Components Qty

A1) Upper Step Tread	1
A2) Lower Step Tread	1
B1) Upper Left Side Riser	1
B2) Lower Left Side Riser	1
C1) Upper Right Side Riser	1
C2) Lower Right Side Riser	1
D) Ballast Tray	1
E) Upper Handrail	1
F) Top Step Support Brace	1
G) Mid Riser Support Brace	1
I) Lower Handrails	2
J) Smart Connector	1

Hardware Kit (not shown) Qty

K) Ballast Sand Bags	2
L) #8 x 1" Screws	8
M) #14 x 1-1/4 Screws	4

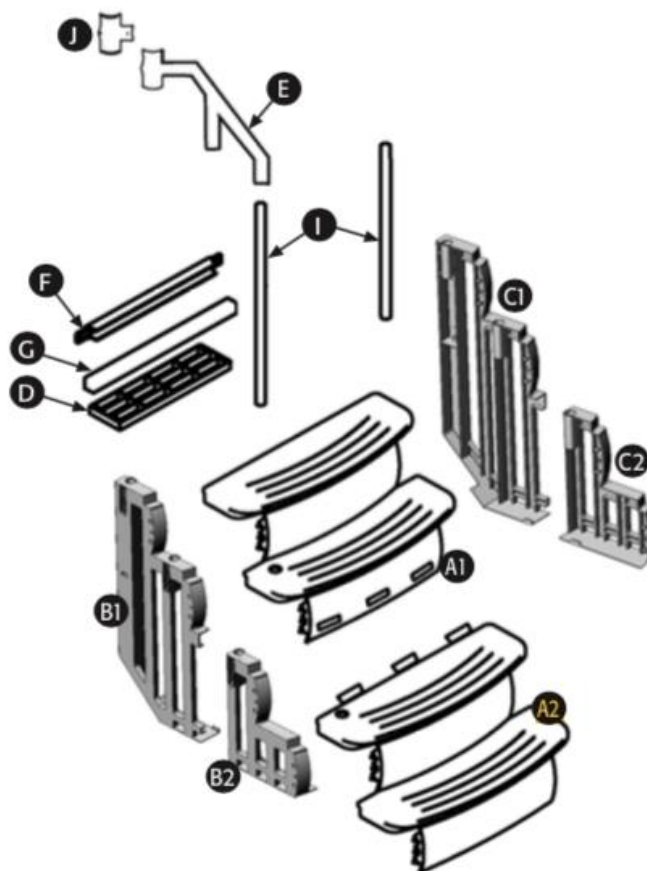

****Replacement Parts Available at MainAccess.com****

SAFETY INSTRUCTIONS:

- Install step per manufacturer's instructions.
- Locate Easy Entry Step on a solid base.
- Easy Entry Step is designed for use by one person at a time.
- This step is intended for use as a swimming pool entry/exit only.
- Face the step when entering and exiting the pool.
- No jumping, no diving from the step.
- Do not swim through, behind or around the step.

Tools Required

Cordless Screwgun/Drill, 1/8" Drill Bit,
Standard Phillips Bit, Safety Glasses

SAND NOT INCLUDED. FLAT BOTTOM POOLS ONLY.

Note: Before you begin the assembly of your ladder/step please insure you have all components and hardware.

Step 1: Align the holes on upper left riser with with mushroom caps on the upper step tread.



Step 2: Snap into place with a rubber mallet.



Step 3: Repeat steps 1 & 2 on the right side of the step.



Step 4: Align the holes on the lower left riser with the mushroom caps on the lower step tread.



Step 5: Snap mushroom caps into place using rubber mallet.



Step 6: Repeat steps 4 & 5 on the right side of the step.



For Questions Regarding Installation, Please Contact Main Access Customer Service 1-888-333-1134



SMART STEP

Model #200600T Assmebly Instructions

Step 7: Insert the tabs from lower step assembly into the slots of the upper step assembly.

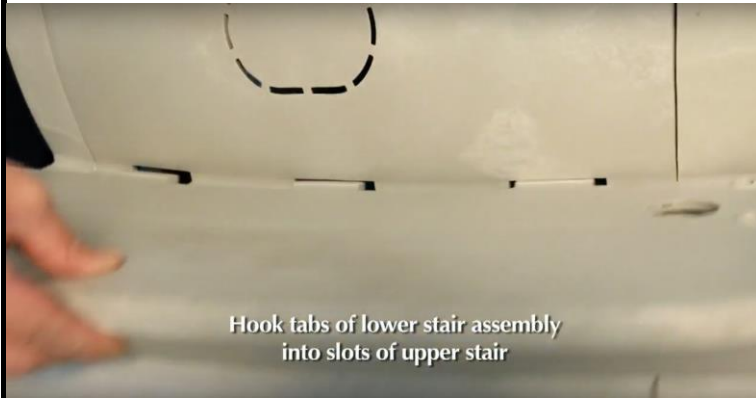

Step 8: Align ballast tray between all four risers under the step.



Step 9: Snap tabs from upper and lower risers into the ballast tray with a rubber mallet.



Step 10: Insert top step support brace in between uppers risers.



Step 11: Insert mid riser brace in between risers and over the tabs. May have to tilt side risers to secure.

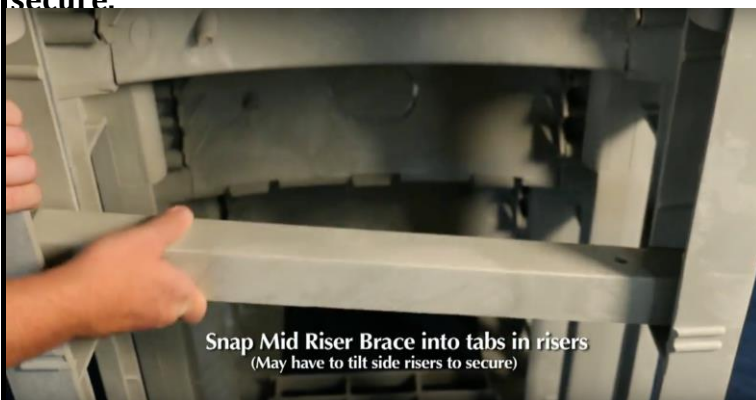

Step 12: Insert a lower handrail into the hole on the second step (lower step tread).



Model #200600T

Step 13: Insert the second lower handrail into the third step (lower hole on the upper step tread).



Step 14: Place upper handrail over both lower handrails and push down until fully seated.



Step 15: Use the socket cap provided to plug the unused hole in the upper step tread.



Step 16: Drill #14 x 1 1/4" screws into handrails through all upper and lower risers.



Step 17: Drill #8 x 1" screws into four dimples on step tread.



Step 18: Use two #8 x 1" screws to secure the upper handrail to the two lower handrails.



For Questions Regarding Installation, Please Contact Main Access Customer Service 1-888-333-1134



SMART STEP

Model #200600T Assmeby Instructions

Step 19: Retrieve Smart Choice Ladder and center Support Feet on top step. Secure feet using (8) 1" screws through hash marks on Support Feet (C).



Step 20: Attach Upper Rail (E) to Smart Choice Handrail (A) using Smart Connector (J) and (2) #8 x 1" screws.



Step 21: Pool Installation

Note: Two people are required for installation.

A total weight of approximately 100 lbs. is required to keep the step from floating once in place under water. With the assistance of another person, carefully place the step in the pool. Place two sealed bags of sand (not included) into the two ballast bags (M) and place over the ballast tray (D) to weigh the step down. Walk the step back against the pool wall to prevent swim-behind hazards.

***Optional* Purchase (2) Anchors (#200888) to weigh down the Smart Step. Sand not included.**

The Anchor



All Finished!



For Questions Regarding Installation, Please Contact Main Access Customer Service 1-888-333-1134

Be sure to check out these other great products from Main Access!

SmartLite

RECHARGABLE UNDERWATER LED LIGHT



Mount it to your step or hang it from the return!

The Anchor



Use them to easily weigh down your pool step!

AQUA CLOUD

OVERSIZED FLOATING MATTRESS



Luxury Pool Floats!



Light-up Floating Globes and Furniture!

MAIN ACCESS

33800 Lear Industrial Parkway

Avon, OH 44011

1-888-333-1134

Info@MainAccess.com

www.MainAccess.com